

2" HYDRAULIC SUBMERSIBLE UTILITY PUMP

MODEL S2TC-2 (Ductile Iron Body)
MODEL S2TCAL-2 (Aluminum Body)
 2" (50 mm) Discharge

The S2TC-2 is a Very Portable and Versatile All Purpose Utility Pump. An Efficient Channel Impeller Handles Solids and Offers Excellent Overall Performance. This Pump is Available With Your Choice of Water or Solids Handling Strainers.



FEATURES

- Efficient Two Channel Impeller will pass 1" (25mm) semi-solids
- Rugged and Reliable Gerotor Motor
- Variable Speed
- Can Be Bolted Into a Pipeline or Staged
- Safe Hydraulic Drive Can Be Used Where Electric Power is Hazardous or Impractical
- Operates With Our Gas, Diesel or Electric Drive Hydraulic Power Units or any open center power source with output flows to 5 GPM.
- Available in standard Ductile Iron or Aluminum body and optional Stainless Steel body.

SPECIFICATIONS

| | |
|---------------------------------|----------------------------------|
| WEIGHT: S2TC-2..... | 25 lbs. (11 kg) |
|S2TCAL-2..... | 17 lbs. (7.7 kg) |
| HEIGHT:..... | 13" (33 cm) |
| DIAMETER (@ widest point):..... | 9 3/8" (24 cm) |
| DISCHARGE:..... | 2" NPT(F) |
| INLET FLANGE:..... | 1 1/2" 125# |
| SOLIDS HANDLING:..... | 1" (25mm) |
| HOSE PORTS:..... | 3/8" SAE 'O' Ring |
| PUMP BODY: S2TC-2..... | Ductile Iron |
|S2TCAL-2..... | Aluminum |
| IMPELLER:..... | Ductile Iron |
| SHAFT:..... | Heat Treated Steel Alloy |
| SHAFT SEAL:..... | Carbon/Ceramic (Std) |
| ELASTOMERS:..... | Buna N (Std) |
| HYDRAULIC OIL:..... | 214-320 s.s.u. @ 100°F (64°C) |
| INPUT FLOW:..... | Max. 5 GPM (19 LPM) |
| OPERATING PRESSURE:... | Cont. Max: 2000PSI (136 Bar) |
| | Int. Max: 2500 PSI (172 Bar) |
| POWER SOURCE:..... | Any Open Center Hydraulic System |

C0701

Specifications subject to change without notice.

Model S2TC-2 Overall Dimensions

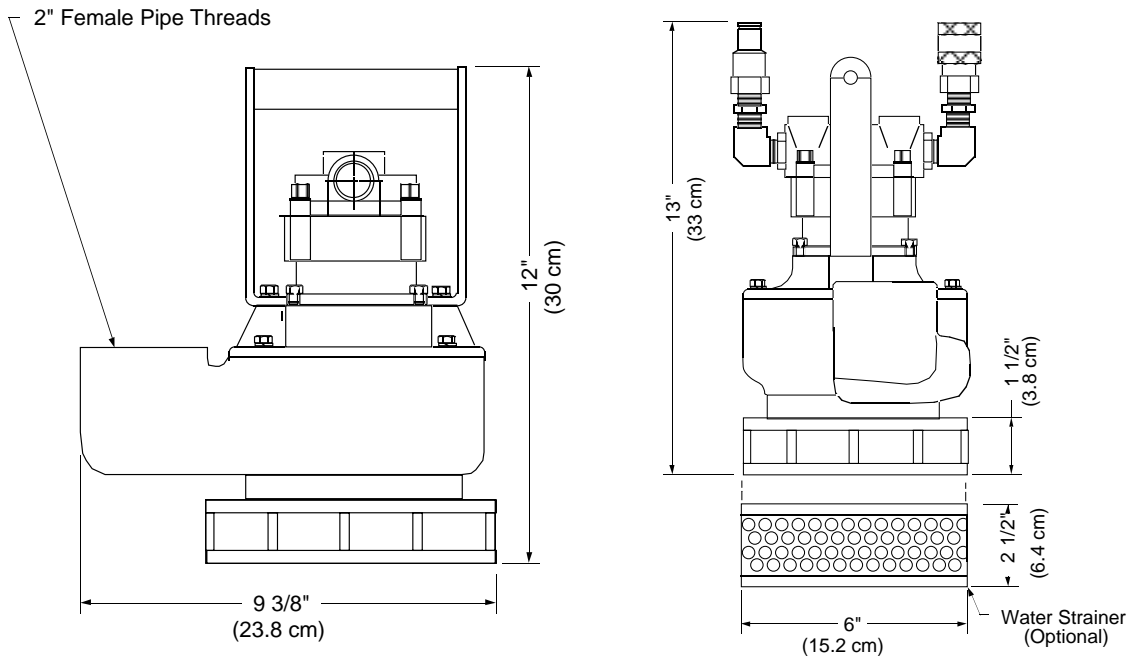

S2TC-2 Typical Performance

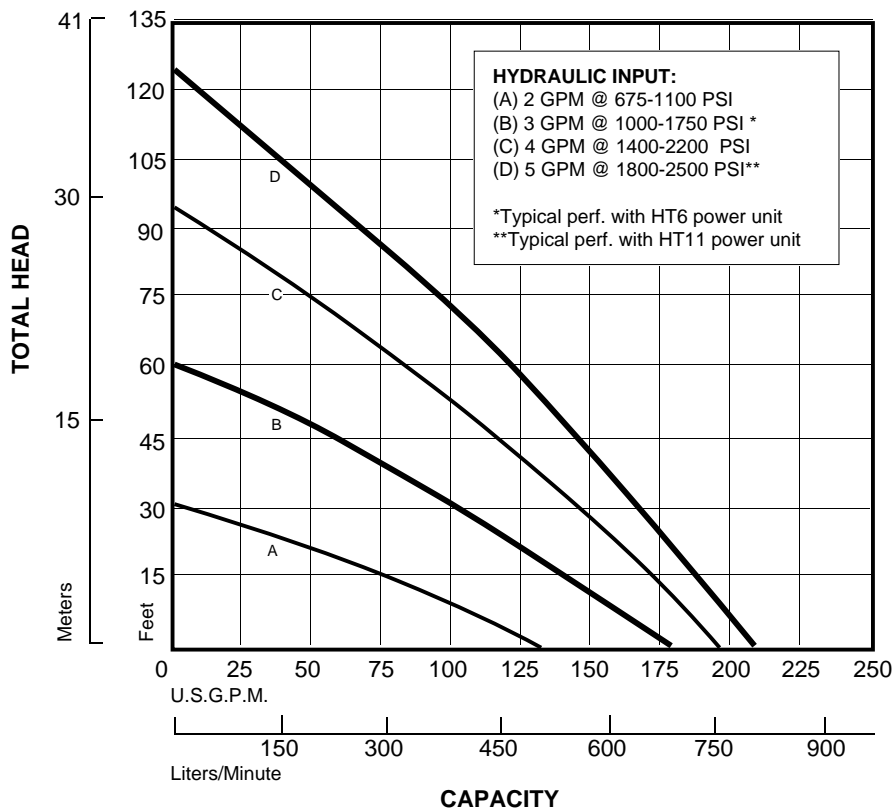

Curves are based on pumping water at 60° F. For Performance Curves other than shown above, Consult Factory.